

pore
enrichment

5 YEAR
WARRANTY

mistaire studio
HUMIDIFIER



USER MANUAL
MODEL: PEHUMSML

TABLE OF CONTENTS

WARNINGS AND PRECAUTIONS	3-4
FCC NOTICE	5
INTRODUCTION & PRODUCT SPECIFICATIONS	6
USING THE HUMIDIFIER.....	7
FUNCTIONS & FEATURES.....	8
CLEANING.....	8-10
TROUBLESHOOTING.....	10-11
WARRANTY & PRODUCT REGISTRATION.....	12

WARNINGS AND PRECAUTIONS

READ THIS ENTIRE INSTRUCTION MANUAL BEFORE OPERATION. BE SURE TO COMPLY WITH ALL “CAUTIONS” AND “WARNINGS”. FAILURE TO ADHERE TO THE FOLLOWING INSTRUCTIONS CAN CAUSE HARM TO YOU OR THE DEVICE.



Only use product as outlined in this manual. Using the product for unintended purposes may result in injury.

- **CAUTION:** Keep this product out of the reach of children and pets.
- Disassembly, repair, or remodeling by an unauthorized person may result in serious harm and will void the manufacturer’s warranty.
- Always place this humidifier on a firm, flat, and level surface. This humidifier may not work properly on an uneven surface.
- Do not place this product on cloth, carpet, or an absorbent surface. This may block air inlet.
- This product releases mist. Do not place this humidifier directly on wood furniture, flooring, or any surfaces that could be damaged by water. Manufacturer does not accept any liability for damage in the case of the unit being placed incorrectly.
- Do not use if the plug is damaged or loose.
- Before filling or cleaning the unit, make sure it is unplugged.
- Once the humidifier has been plugged in, do not tilt or move the unit.
- Do not remove the water tank from the unit while it is on.
- Do not handle the plug with wet hands.
- Do not excessively bend, twist, pull, or damage the power cord.
- Avoid placing this product where the humidity spout is pointed directly at an object or person.
- Do not inhale the mist/vapor that is expelled from the humidifier or drink water from the tank.
- Do not fill the water tank with hot or boiling water.
- Do not use this product in direct sunlight or near a heat source such as a stove, heater, or radiator.

WARNINGS AND PRECAUTIONS

- If the water tank becomes cracked or damaged, do not use.
- Do not keep this product running unattended for an extended period of time. Never leave it running unattended around children.
- Unplug the cord when the unit is not in use for an extended period of time and/or when no one is home.
- Do not keep water in the tank when not in use for an extended period of time.
- Use only the cleaners and additives recommended on Pages 8-10 of this manual to clean the water tank.
- The use of water additives including essential oils, fragrances, eucalyptus, water conditioners, etc. will damage the appliance materials, and as a consequence, the whole unit.
- Do not use this product near any other electronic device.
- Do not cover the mist nozzle at any time during use.
- Do not put any objects on or in the tank.
- When unplugging the power cord from an electrical outlet, hold the humidifier securely.
- Do not place the power cord over objects.
- Do not get water in or on the power cord or where it connects to the product.
- Do not allow water to enter the air outlet at the bottom of the unit while cleaning or using.
- Do not use when plugged in near a sink.
- Do not touch the water tank during operation.
- Do not submerge the unit in water or pour water on the unit or in the humidity spout.
- Do not cover the humidity spout with a cloth or hand and do not use without the humidity spout.
- Use clean or distilled water in the tank. Hard water areas will require more frequent cleaning.

FCC NOTICE

Model: MistAire Studio (PEHUMSML)

This device complies with Part 18 of the FCC rules.

Pure Enrichment
2803 S Yale St
Santa Ana, CA 92704
pureenrichment.com

This equipment generates, uses, and can radiate radio frequency energy, and if not installed and used in accordance with the instructions, may cause harmful interference with radio communications. The equipment should be maintained as discussed in this manual. Changes or modifications not expressly approved by Pure Enrichment will void the user's authority to operate the equipment. If this equipment does cause harmful interference with radio or television reception, which can be determined by turning the equipment off and on, the user is encouraged to try to correct the interference by one or more of the following measures:

- Reorient or relocate the receiving antenna.
- Increase the separation between the equipment and receiver.
- Connect the equipment into an outlet on a circuit different from that to which the receiver is connected.
- Consult dealer or experienced radio/TV technician for help.

INTRODUCTION

Thank you for purchasing MistAire Studio by Pure Enrichment. This powerful small humidifier is the ideal solution for moisturizing dry air in your personal space or in small rooms. The diagram below explains all of the components you will find inside the box. Setup is quick and easy, but be sure to follow all instructions to ensure safe and effective use.

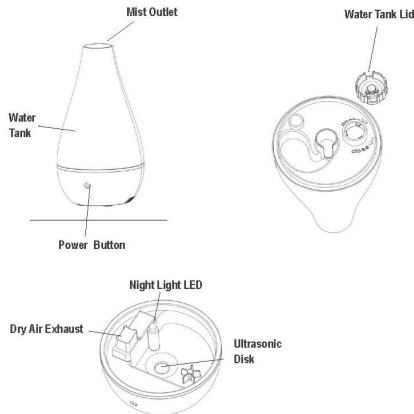

PRODUCT SPECIFICATIONS

Size:	5" (W) x 5" (D) x 9" (H)
Power:	AC 100-240V, 50/60Hz, 12W
Room Coverage:	Up to 200 ft ²
Max Run Time*:	9 hrs (high); 12 hrs (low)
Tank Capacity:	0.7L (34fl oz)
Moisture Output:	≤60ml/hr on low; ≥80ml/hr on high
Noise:	<32dB

*Run time may vary depending on water quality and room temperature.

USING THE HUMIDIFIER

SETUP

Before you set up the humidifier, select a location that is firm, level, and flat. For proper airflow, the location should be at least six inches from the nearest wall or object. Place the humidifier on a water-resistant surface, as water can damage furniture and some flooring.

Do not place the product directly on carpet, towels, blankets or other absorbent surfaces. Pure Enrichment will not accept responsibility for property damage caused by water spillage.

FILLING

Make sure unit is unplugged.

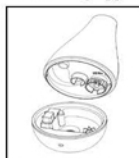

1. Separate the tank from the base of the unit.

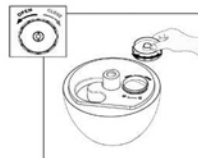

2. Flip over water tank and open the tank lid, turning it to the left.



3. Pour cool, clean water directly into the tank. Do not pour anything but water into the tank.

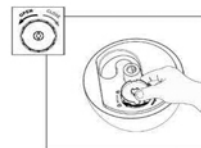

4. Close the tank lid, turning it to the right. It is important to FIRMLY secure cap after filling the tank with water.

5. Attach tank to base of unit.

NOTE: Make sure there is water in the unit before turning it on.

FUNCTIONS & FEATURES

Power Button

The power button on the humidifier controls both the high and low mist settings as well as the optional night light in the following manner:

- **1st press: low setting, light off**
- **2nd press: low setting, light on**
- **3rd press: high setting, light on**
- **4th press: high setting, light off**

The blue light on the power button displays when the unit is working correctly. After about 10 seconds at the desired setting, the blue light in the power button turns off automatically. When the unit runs out of water, the light will turn red, and the unit will shut off. Simply add more water to continue to use.

Cleaning Brush

The humidifier includes a cleaning brush that should be used to keep the ultrasonic disk free from dust and debris.

CLEANING

Always unplug the humidifier before servicing it in any way.

NOTE: Do not allow water to enter the air outlet at the bottom of the unit while cleaning or using.

General Cleaning

- **Inside the base of the unit.** Pour excess water out of the unit. Wash out the unit with fresh water using the cleaning brush and a soft cloth as needed. Do not submerge the base of the unit in water or allow water to enter inside the dry air exhaust port of the unit.
- **Water tank.** Empty water tank. Remove mist nozzle and clean the mist tube with fresh water and a bottle cleaning brush (not included).

General Cleaning (CONT'D)

- **Outer surface of the unit.** Wipe the surface of the unit with a soft, damp cloth if needed. If you notice an accumulation of water during usage, reduce humidity and dry outer surface with a cloth.

Descaling

- Depending on usage and water type, cleaning to remove scale may be required weekly or every other week to optimize the product's performance.
- If you live in a hard water area, we recommend distilled water for your humidifier to help reduce the precipitation of minerals or white dust.
- Do not clean the unit or water tank with harsh detergents or cleaning chemicals. A decalcification cartridge or humidifier cleaner capsule may be used to keep the water tank free of hard mineral deposits.

Ultrasonic Disk

1. Unplug the humidifier.
2. Remove the tank and empty all water from the base and tank.
3. Locate the ultrasonic disk using the diagram on page 6.
4. Use the enclosed cleaning brush to gently clean and remove build up and deposits.

NOTE: Do not scrub or scrape the ultrasonic disk.

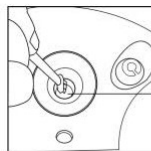

*Clean the disk with the brush only. No other cleaning tool should be used.

Ultrasonic Disk

CLEANING (CONT'D)

If scale becomes difficult to remove with brush:

1. Fill the base with a mixture of 1 tsp. white vinegar and 1 tsp. water.
2. Let the solution stand for 5 minutes.
3. While the vinegar is in the base, clean all of the interior surfaces with a soft cloth or brush to help remove scale.
4. Check for buildup in the mist nozzle and mist tube. Clean as needed.
5. Rinse the base thoroughly with water to remove scale and all of the vinegar solution.
6. If minerals in your water are producing a white dust, you may use a decalcification cartridge or humidifier cleaner cartridge to keep the tank clean.

END OF SEASON STORAGE

- Follow the General Cleaning and Descaling instructions on pages 8-9 to get your humidifier ready for storage at the end of the season.
- Dry the humidifier completely before storing. DO NOT store with water inside the base or water tank.
- Pack the unit in its original box and store in a cool, dry location.

NOTE: IF YOU EXPERIENCE A PROBLEM WITH THIS PRODUCT, DO NOT ATTEMPT TO OPEN THE MOTOR HOUSING BY YOURSELF. DOING SO MAY VOID YOUR WARRANTY AND CAUSE DAMAGE TO THE HUMIDIFIER OR PERSONAL INJURY.

TROUBLESHOOTING

If you are having problems with your humidifier, see if one of the solutions below resolves the problem before contacting Pure Enrichment.

Problem	Solution
Water vapor and humidity are not being produced.	Power plug: Unplug and then try again. Power Failure: When power returns, try again. Tank Installation: Ensure tank is attached properly. Dirty ultrasonic disk: Clean disk (see page 9)
Air blows but water vapor is not produced.	Excessive Water: Pour out extra water. Residue inside tank: Wash tank and try again. Dirty ultrasonic disk: Clean disk (see page 9) If you use hard water, replace with softer water.
Humidity level is low.	Dirty ultrasonic disk: Clean disk (see page 9) Water in unit is too cold: Replace with cool water.
The humidity has a bad smell.	Poor maintenance or dirty water: Clean humidifier thoroughly, and fill with fresh water.
White dust is forming on nearby furniture.	Hard water may deposit dust: Dust in the air also settles because of added humidity in the room. Use distilled water if it persists.
Humidifier has stopped working.	No or low water: Unplug unit and refill tank.
Water is accumulating outside of unit or area surrounding unit.	Saturation of humidity: Lower mist control setting. Unit not level and water is accumulating: Unplug and place on level surface. Point spray away from objects: Raise unit on a water-resistant level surface 2-3 feet off of floor.
Water dripping when refilling.	Water remaining on bottom of tank: Wipe tank or tilt to drain before transporting.
Increased noise level.	Unit must be placed on a flat, level, hard surface: Make sure it is NOT placed on a soft or absorbent surface.
Red light on power dial.	Red LED light indicates low water: Unplug and refill tank.

WARRANTY

MistAire Studio comes with an industry-leading 5 Year Warranty that begins on the date of purchase.

The warranty applies to the humidifier and necessary parts and labor relating thereto. The warranty does not apply to damage resulting from failure to follow the operating instructions, accidents, abuse, alterations or disassembly by unauthorized individuals.

PRODUCT REGISTRATION

To ensure your full warranty and to receive product updates and streamlined customer support, remember to register your product at:

pureenrichment.com/productregistration

PRODUCT SUPPORT

We've got you covered with a hassle-free warranty and friendly product support that responds within 1 business day.

help@pureenrichment.com

(657) 275-3737

(Available Monday-Friday, 8am-5pm PST)



Santa Ana, CA 92704
pureenrichment.com